

FL93CAI

Self-priming centrifugal pump

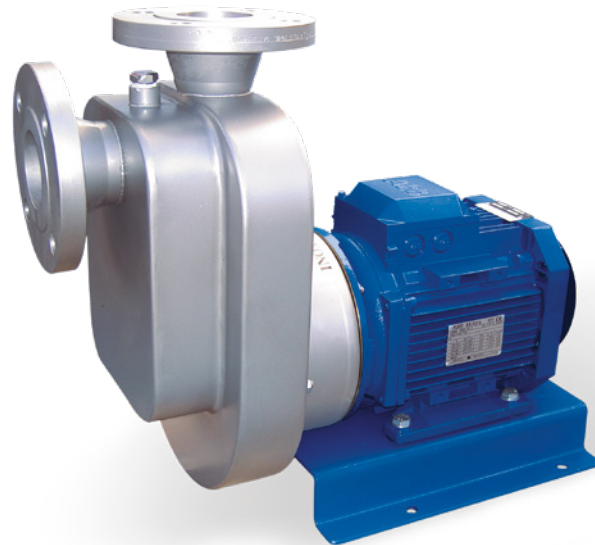

APPLIICATIONS

FL93CAI food centrifugal pumps are used mainly for decanting liquids in the food, chemical and winery industries in applications where suction with load is not possible. The simplicity of the pump parts allows straightforward maintenance. The level of the finish and the pump design ensure a high degree of hygiene.

CHARACTERISTICS

Level of finish: Foodstuff / Industrial
 Half-open impeller
 Hygienic seal
 Simplicity of parts
 BSP/DIN 11851 connections

OPTIONS

Cover
 Open impeller
 Other connections: DIN 2576, CLAMP, SMS, RJT, etc.
 Trolley, platform
 Dual mechanical seal with thermosiphon cooling system
 Control panel



PERFORMANCE CURVES FL93CAI

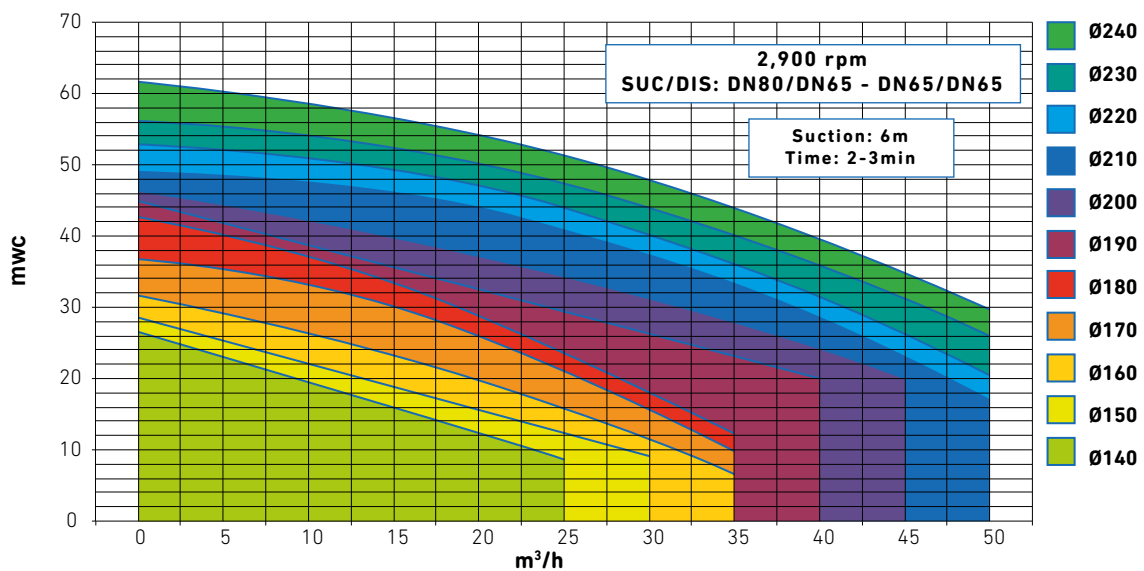

(for other impeller and motor combinations, please ask)

DIMENSIONS AND CHARACTERISTICS OF FL93CAI MODEL

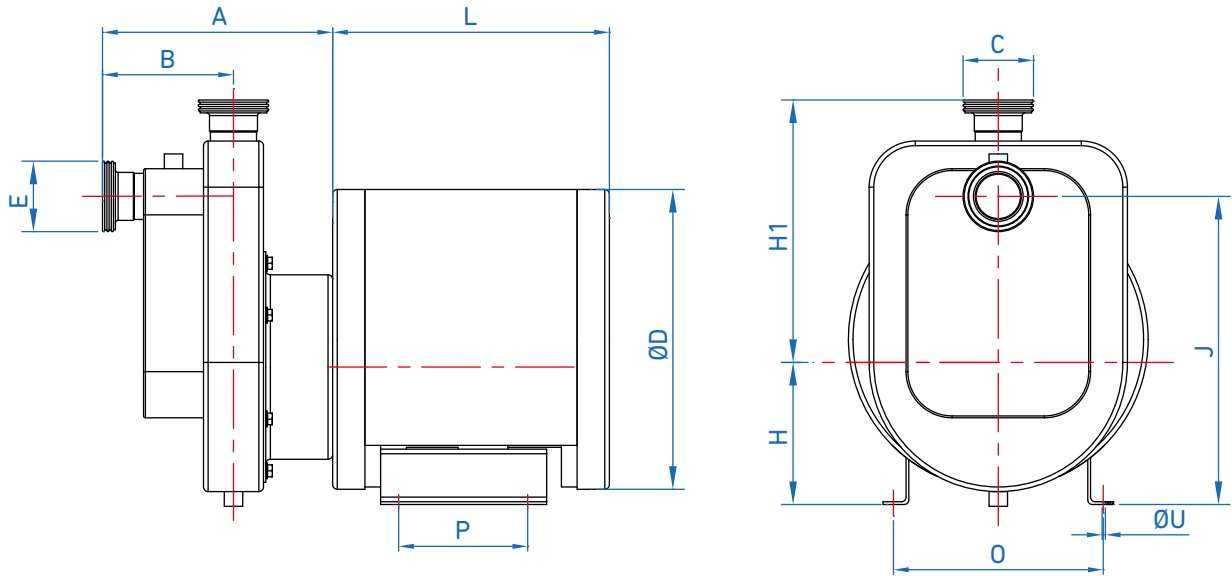

MODEL	MOTOR		DIMENSIONS											
	CV	kW	A	B	C	D	E	H	H1	J	L	O	P	U
FL93CAI	7.5	5.5	369	210	2 ½" BSP	Ø220	2 ½" BSP	150	386	450	350	335	300	Ø12
	10	7.5				Ø220		150		450	377	335	300	Ø12
	12	11				Ø264		160		478	468	375	400	Ø12
	20	15	398			Ø264	3" BSP	172		478	495	375	400	Ø12
	25	18.5				Ø310		192		478	495	375	400	Ø12
	30	22				Ø310		192		497.5	495	420	450	Ø14

MATERIALS LIST

PUMP

Lamp

STAINLESS STEEL AISI 304

Body

Impeller

Shaft

Connections

STAINLESS STEEL AISI 316

MECHANICAL SEAL

Fixed part

Graphite

Tungsten

Graphite

Rotatory part

SS

Tungsten

SS

Gaskets

NBR

Nitrile

Viton

(For other materials, please ask)

MOTOR

Protection IP55

50 Hz 220-380V/380-690V